

**Job Name:** \_\_\_\_\_  
**Purchaser:** \_\_\_\_\_  
**Submitted To:** \_\_\_\_\_  
**Submitted By:** \_\_\_\_\_  
**Unit Designation:** \_\_\_\_\_

**Location:** \_\_\_\_\_  
**Engineer:** \_\_\_\_\_  
**For:**  Reference  Approval  Construction  
**Date:** \_\_\_\_\_

**Connected to ERLQ018:**

Nominal pump ESP (Heating)	7.1 psi
Nominal pump ESP (Cooling)	7.4 psi
<b>Waterside Heat Exchanger :</b> Volume	0.18 gal
Flow rate Min/Max	3.17/11.09 gpm
Nominal flow rate (Heating)	4.35 gpm
Nominal flow rate (Cooling)	3.88 gpm

**Connected to ERLQ024:**

Nominal pump ESP (Heating)	6.5 psi
Nominal pump ESP (Cooling)	8.5 psi
<b>Waterside Heat Exchanger :</b> Volume	0.18 gal
Flow rate Min/Max	3.17/11.09 gpm
Nominal flow rate (Heating)	5.18 gpm
Nominal flow rate (Cooling)	4.44 gpm

**Connected to ERLQ030:**

Nominal pump ESP (Heating)	5.5 psi
Nominal pump ESP (Cooling)	7.0 psi
<b>Waterside Heat Exchanger :</b> Volume	0.18 gal
Flow rate Min/Max	3.17/11.09 gpm
Nominal flow rate (Heating)	6.37 gpm
Nominal flow rate (Cooling)	4.60 gpm

**Connected to all Outdoor units:**

Expansion Vessel Volume	2.64 gal
Max. water pressure	43.5 psi
Pre Pressure	14.5 psi
Water Inlet/Outlet Piping Connt.	1" Male BSP
Total water volume	5.5 gal
Leaving Water Temp (Heating)	(59) 77~131°F* [(15) 25~55°C]
Leaving Water Temp (Cooling)	41~71.6 (122°F) [5~22 (55°C)]
Refrigerant Connection - Gas side	5/8" OD (flare)
- Liquid Side	1/4" OD (flare)
<b>Pump:</b> No. of speed	3

\*Back up heater operation between 59°F(15°C) and 77°F(25°C)

**Power Supply:**

Main Power (fed from outdoor unit)	208-230V/1Ph/60Hz
Back-up Heater Power Supply	208-230V/1Ph/60Hz
Back-up heater capacity	3 kW
Minimum Circuit Amps (MCA)	14.3 Amps
Maximum Overcurrent Protection (MOP)	20.0 Amps

**Unit Data:**

Dimensions (HxWxD)	36-5/16 x 19-3/4 x 14-7/32
Weight	101 lbs

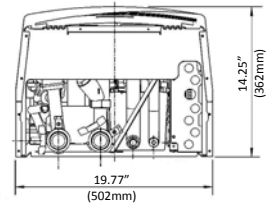
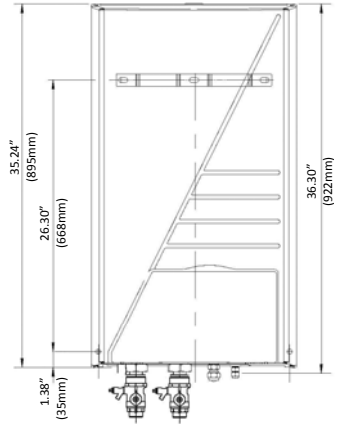

For further information about the installation, please refer to the Installation and Engineering Guides

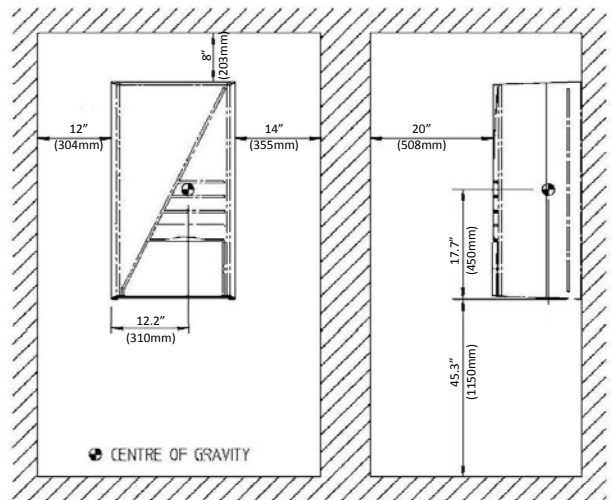

**Service & Clearance Space Hydrobox**

**Standard Features:**

Parts warranty	5 years
Limited labor warranty	1 year

**Options:**

BSP to NPT Connection Adaptor	DACA-HBA-1
Condensate kit For Cooling Mode.	EKHBDP